

# MERCEDES ESL

Julie™ Car Emulator instruction manual

## ESL/ELV REPLACING PROGRAM



### Table of contents

		PHOTO	PINOUT
Page 2	• Program introduction		
Page 3	• <b>Mercedes Sprinter II W906 / VW Crafter*</b>		
Page 4	• <b>Vito W639 / W211 / W209 / W203</b>		
Page 5	• <b>W210 / W208 / W202</b>		

\*Solution for Volkswagen Crafter requires Julie version 105 or later

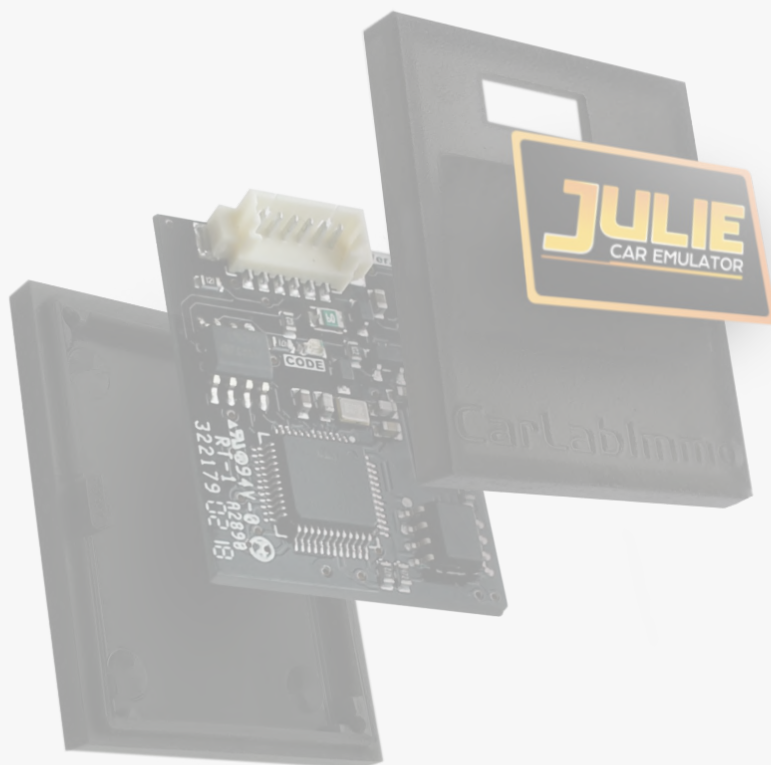

## ● Program introduction



### Example cars

#### Mercedes with ESL / ELV

C-class - W203  
C-class - W202  
CLK - W209  
CLK - W208  
E-class - W211  
E-class - W210  
Sprinter II W906  
Vito W639

#### Volkswagen with ESL / ELV

Crafter\*

\*Solution for Volkswagen Crafter requires Julie version 105 or later

### ● ● ● Jumpers to solder

Choose the Julie™ program by soldering the following jumpers depending on your car brand:

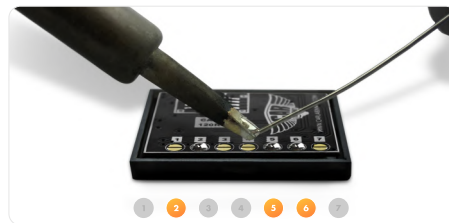

To choose the program you have to solder specific jumpers on the back of the Emulator:

**2 + 5 + 6**

## Mercedes Sprinter II W906 (up to 2010) / VW Crafter\*

\*Solution for Volkswagen Crafter requires Julie version 105 or later



1

Disconnect plug from ESL

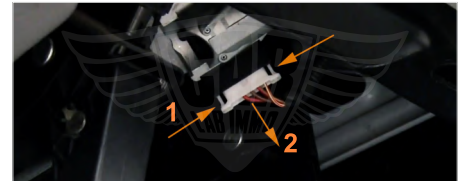

2

To choose the program you have to solder specific jumpers on the back of the Emulator:

**2 + 5 + 6**

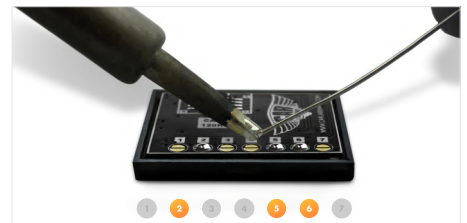

3

Connect Julie to the ESL's plug according to the picture on the right.

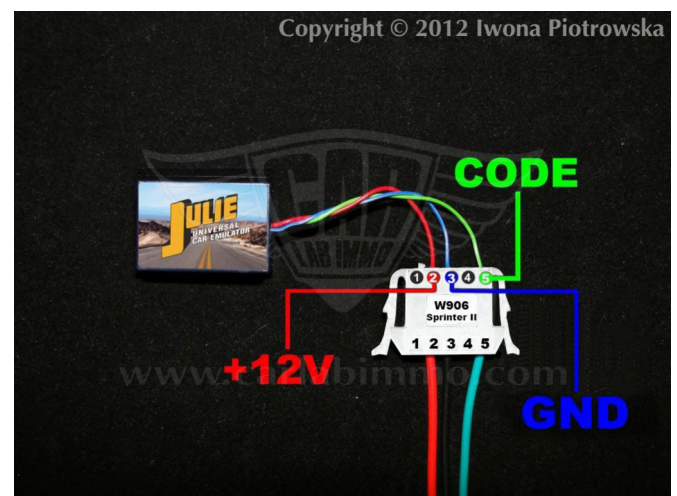

4

Check the Julie's™ LED behaviour

If the procedure is successfully completed the

blue LED lights constantly and blinks once every two seconds!

End of the procedure

● **Vito W639 / W211 / W209 / W203**

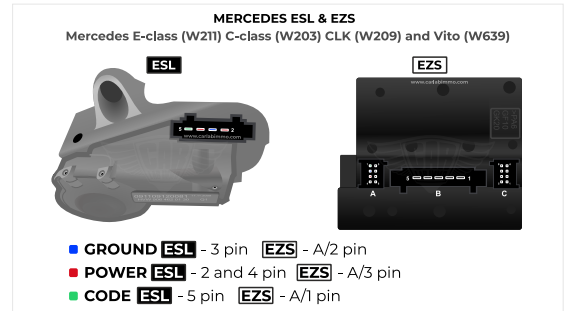

1

Disconnect plug from ESL



2

To choose the program you have to solder specific jumpers on the back of the Emulator:

**2 + 5 + 6**

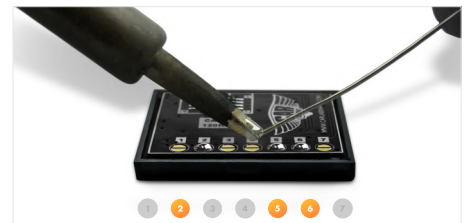

3

Connect Julie to the ESL's plug according to the picture on the right.

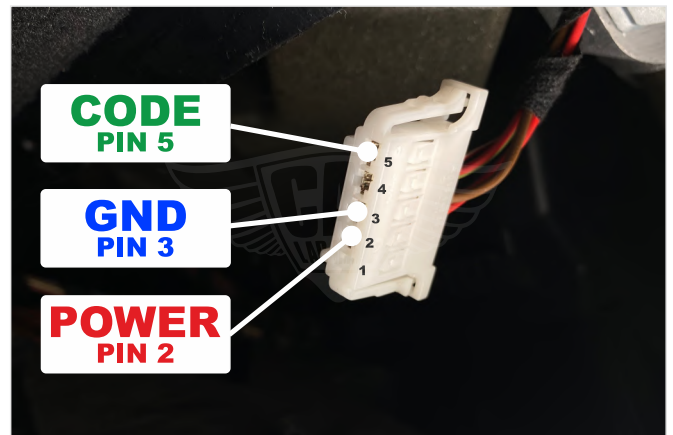

4

Check the Julie's™ LED behaviour

If the procedure is successfully completed the

blue LED lights constantly and blinks once every two seconds!

End of the procedure

## ● W210 / W208 / W202

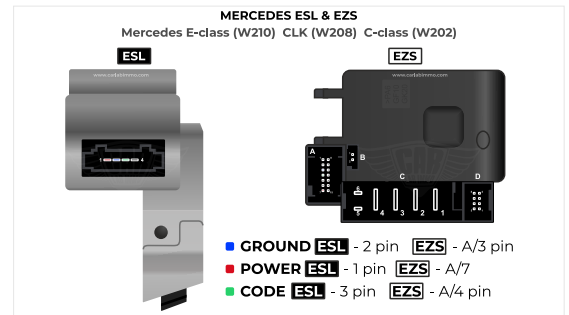

1

Disconnect plug from ESL

2

To choose the program you have to solder specific jumpers on the back of the Emulator:

**2 + 5 + 6**

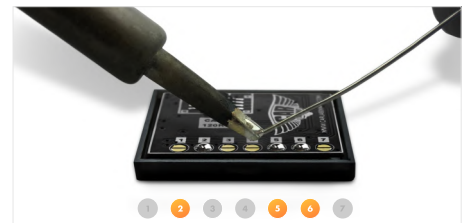

3

Connect Julie to the ESL's plug according to the picture on the right.

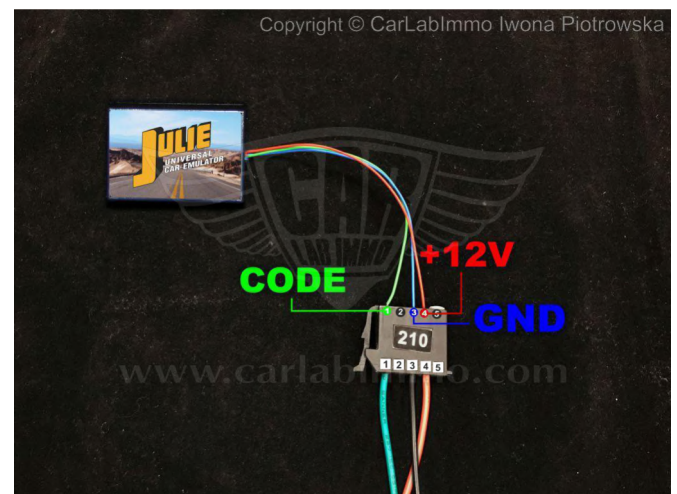

4

Check the Julie's™ LED behaviour

If the procedure is successfully completed the

blue LED lights constantly and blinks once every two seconds!

End of the procedure

# VOLVO ESL

Julie™ Car Emulator instruction manual

Instruction manual

## ESL (SCL) REPLACING PROGRAM



### Table of contents

Page 2	• Program introduction	VERSION	PHOTO	PINOUT
Page 3	• <b>VOLVO ESL</b>	111		

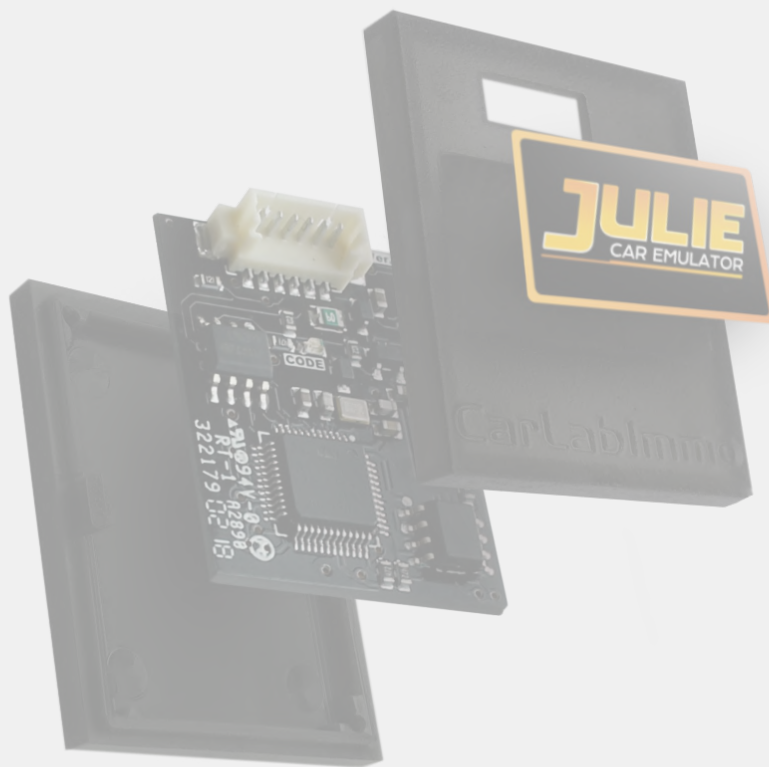

## ● Program introduction

The emulator is an easy fix to a very common issue with Steering Column Lock (SCL). It works by replacing an original ESL signal. In case of a locked SCL, it is required to physically remove it from the vehicle. The emulator will simulate the electronic signal of SCL, enabling the car to start.



When the steering lock gets damaged, an SCL error shows up on the dashboard and the car won't start.

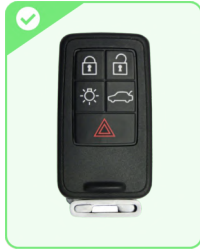

The emulator works only with **VOLVO SMART REMOTE** key.

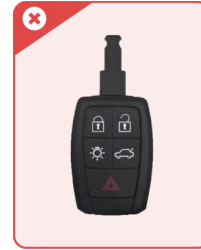

**VOLVO KEY REMOTE**  
*is not supported!*

Connect the device directly to the plug leading to SCL (in the place of the damaged lock) and start the car. No adaptation required!

### **i** Program usage

The emulator can be used with VOLVO vehicles equipped with a 4-pin ESL plug (only 3 pins out of 4 are inserted)

### **🚗** Example cars

#### **VOLVO**

S40/V40  
S60/V60  
S80  
XC60  
XC70

### **🔗** Jumpers to solder

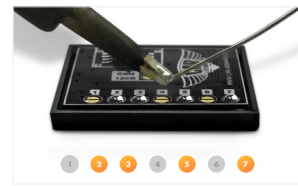

**2 + 3 + 5 + 7**

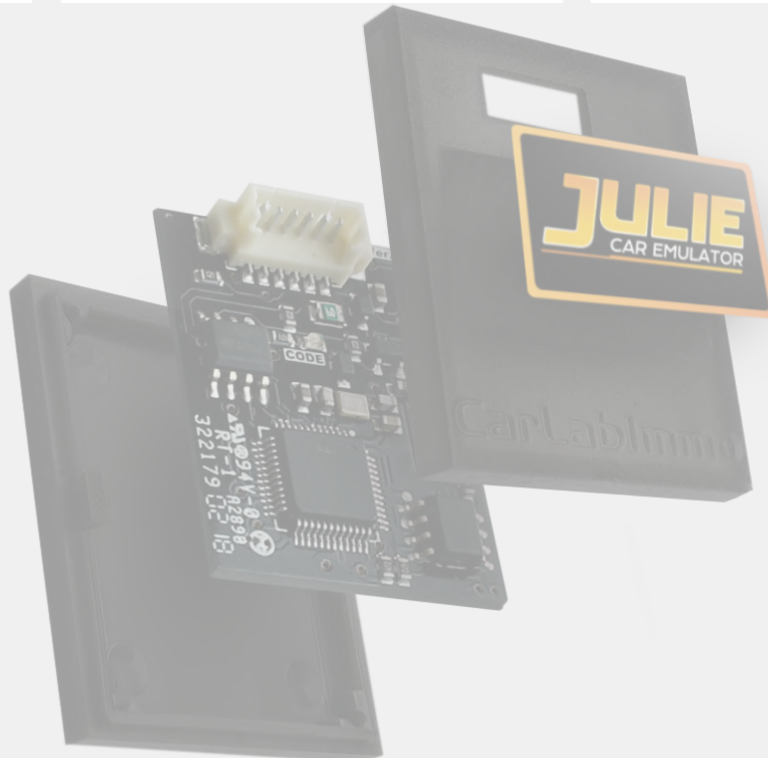



## ● VOLVO ESL

**This procedure for Julie Emulator works in the same way as Clixe Volvo ESL, with one exception - Julie is NOT equipped with a dedicated plug. Instead, the procedure requires soldering the wires into the original ESL plug.**

- 1 Disconnect plug from the SCL and remove the damaged SCL module from the car



- 2 Choose the Julie program by soldering the following jumpers:

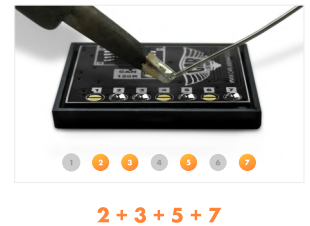

- 3 Remove the resistor marked on the picture

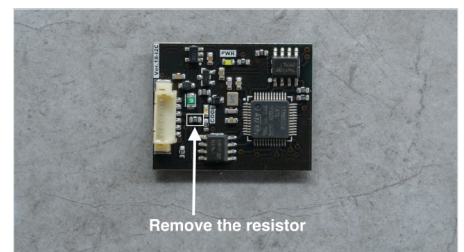

- 4 Connect the Emulator to the ESL plug according to the pictures on the right.

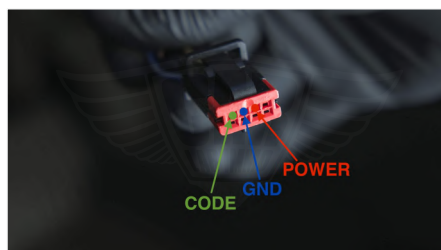

### **i Attention!**

The emulator can be used with VOLVO vehicles equipped with a 4-pin ESL plug (only 3 pins out of 4 are inserted)

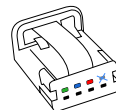

- 5 Start the car.

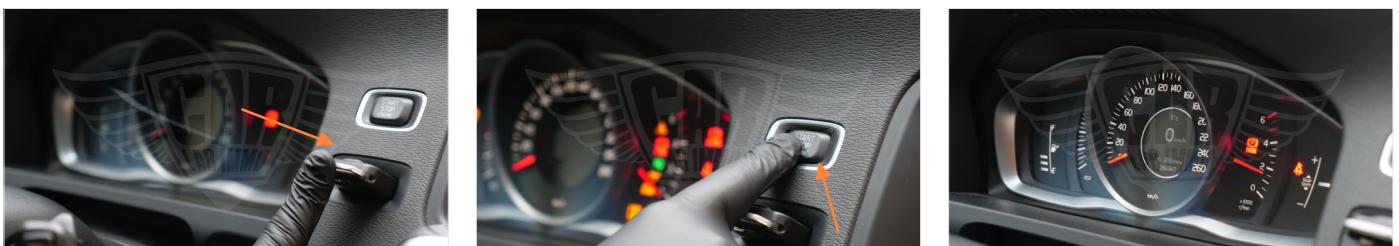

End of the procedure



# BMW ESL

Julie™ Car Emulator instruction manual

## ESL/ELV REPLACING PROGRAM



### Table of contents

- Page 2 · Program introduction
- Page 3 · **BMW ESL**

VERSION

PHOTO

PINOUT

109

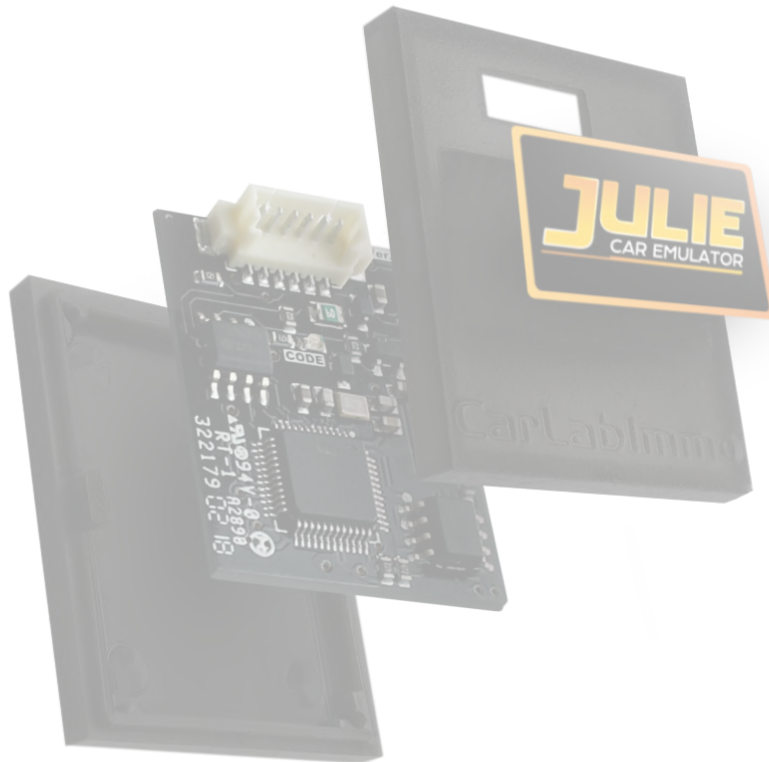

# Program introduction

The emulator replaces the **Electronic Steering Lock (ESL)** signal.

Symptoms of a malfunctioning or damaged ESL:

- The car doesn't start
- The car doesn't react to the start&stop button
- ESL warning light icon (**red** or **yellow**) lights up on the dashboard



For the emulator to start, it needs to be connected to the car's wiring after disconnecting it from a damaged ESL. The original ESL needs to be removed from the car.

**It is necessary to reset the fault counter in the CAS module.**



## Program usage

The emulator can be used with BMW / MINI vehicles equipped with a 3 or 4-pin ESL plug



## Example cars

### BMW

Series 1  
E81, E82, E87, E88  
Series 3  
E90, E91, E92, E93  
Series 5  
E60, E61  
Series 6  
E63, E64

### MINI

R55  
R56

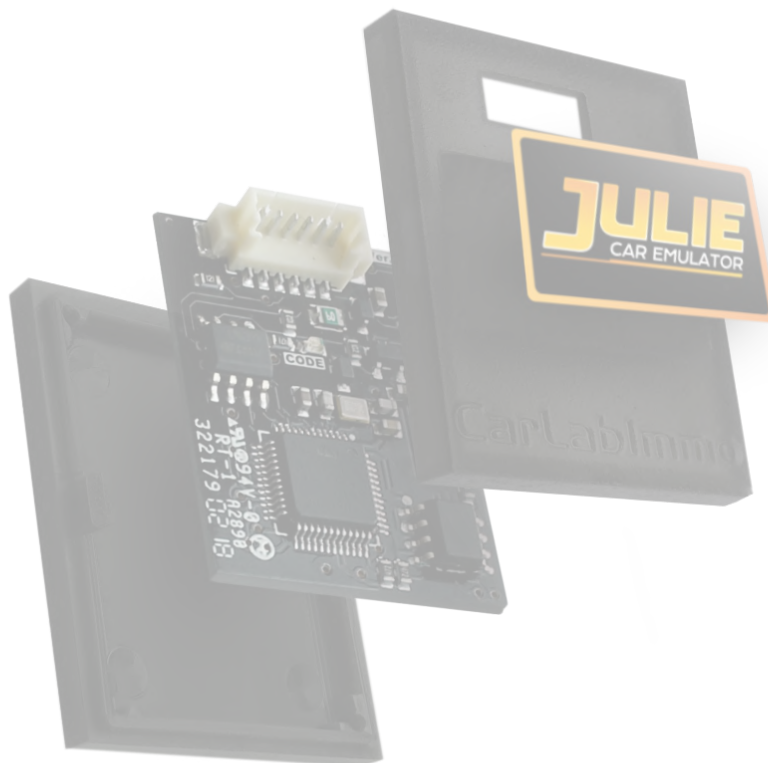

## ● BMW ESL

### Supported cars

#### BMW

Series 1  
E81, E82, E87, E88  
Series 3  
E90, E91, E92, E93  
Series 5  
E60, E61  
Series 6  
E63, E64

#### MINI

R55  
R56

1

Disconnect plug from the ESL and remove the ESL module from the car

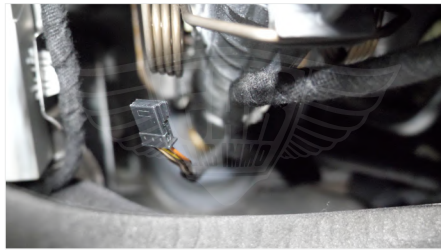
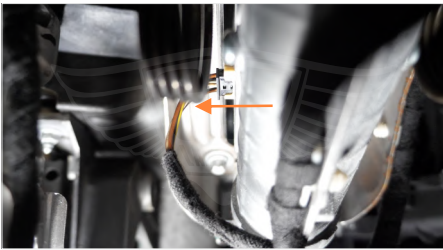

2

To choose the program you have to solder specific jumpers on the back of the Emulator:

5

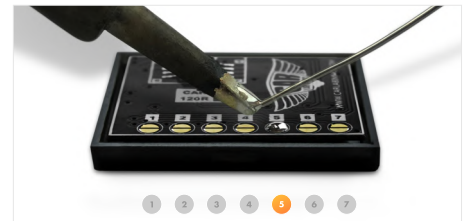

3

Connect the Emulator to the ESL plug according the diagram on the right

**i Attention!**

**It is necessary to reset the fault counter in the CAS module.**

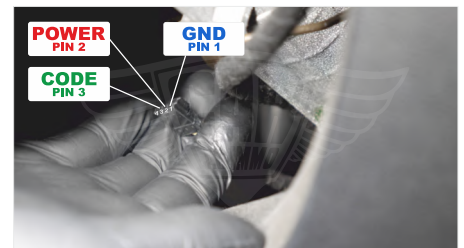

4

Start the car.



End of the procedure

# RENAULT ESL

Julie™ Car Emulator instruction manual

ESL/ELV REPLACING PROGRAM



## Table of contents

		MIN. VERSION	PHOTO	PINOUT
Page 2	• Program introduction			
Page 3	• <b>Renault ESL 3</b>	108		
Page 4	• <b>Renault ESL 2</b>	108		
Page 5	• <b>Renault ESL 1</b>	108		

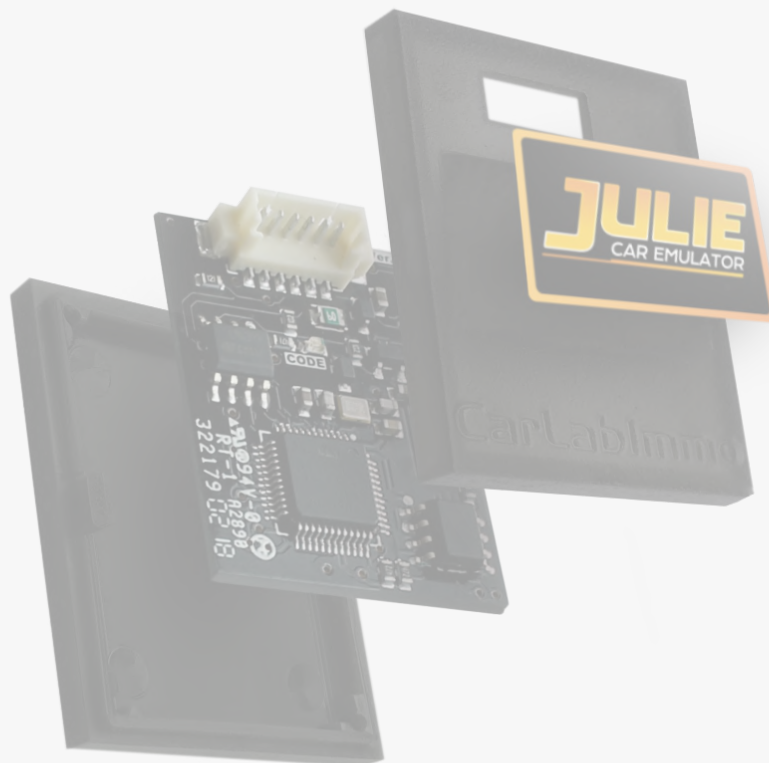

## ● Program introduction



### Example cars

#### Renault

Captur  
Clio III  
Clio IV  
Espace IV  
Espace IV (phase II)  
Espace IV (phase III)  
Fluence  
Laguna II  
Laguna II (lift 2004-2006)  
Laguna III

Megane II  
Megane II (lift 2004-2006)  
Megane III  
Scenic II  
Scenic III  
Talisman

### ● ● ● Jumpers to solder

To choose the program you have to solder specific jumpers on the back of the Emulator:

ESL 1

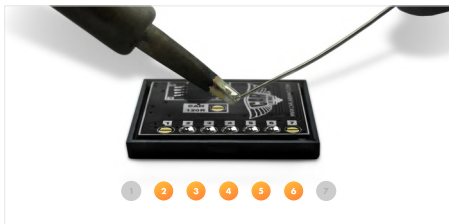

2 + 3 + 4 + 5 + 6

ESL 2

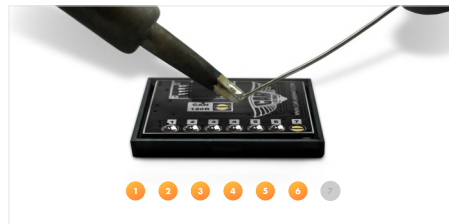

1 + 2 + 3 + 4 + 5 + 6

ESL 3

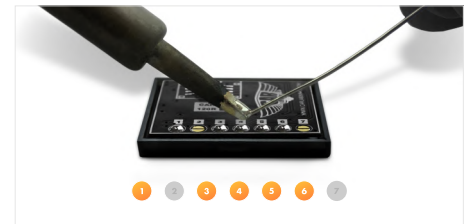

1 + 3 + 4 + 5 + 6

If the Emulator doesn't work, solder an additional jumper CAN 120R



## Renault ESL 3

### Supported cars

Renault Laguna II (lift 2004-2006)  
Renault Megane II (lift 2004-2006)  
Renault Espace IV (2004-2006)

### 1 Disconnect plug from ESL



### 2 To choose the program you have to solder specific jumpers on the back of the Emulator: **1 + 3 + 4 + 5 + 6**

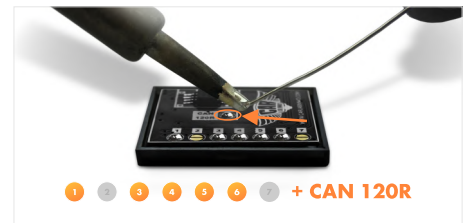
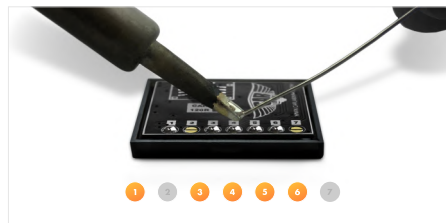

### 3 Connect Julie to the ESL's plug according to the picture on the right.

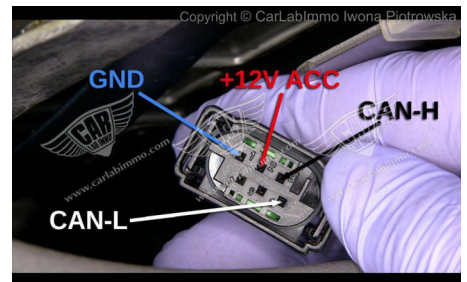
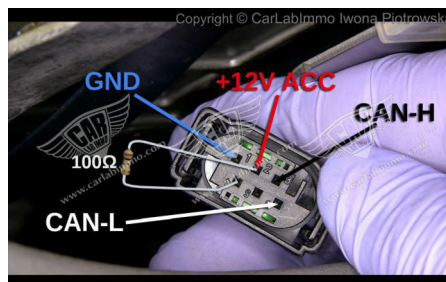

**i Attention!**

- If the Emulator doesn't work, solder an additional jumper CAN 120R
- If SERVICE warning appears on the dashboard, take out the 100Ω resistor between pins 2 and 4 of the emulator's plug

### 4 Start the car.



### 5 Check the Julie's™ LED behaviour If the procedure is successfully completed the blue LED lights constantly and blinks once every two seconds!

End of the procedure

## Renault ESL 2

### Supported cars

Renault Talisman Renault Laguna III  
 Renault Captur Renault Espace IV (phase III)  
 Renault Clio IV  
 Renault Megane III  
 Renault Scenic III  
 Renault Fluence

1 Disconnect plug from ESL



2 To choose the program you have to solder specific jumpers on the back of the Emulator:  
**1 + 2 + 3 + 4 + 5 + 6**

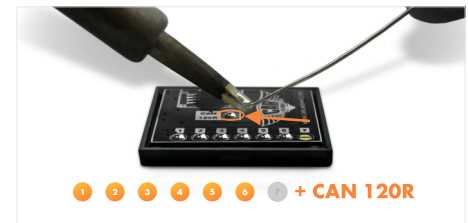
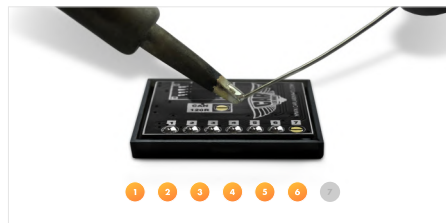

3 Connect Julie to the ESL's plug according to the picture on the right.

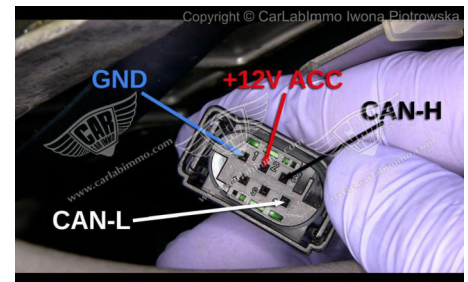
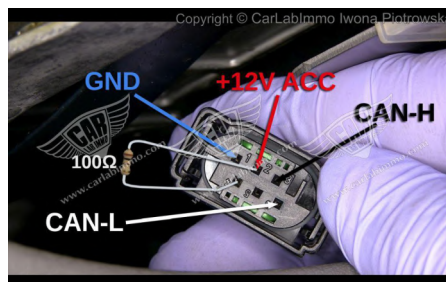

**i Attention!**

- If the Emulator doesn't work, solder an additional jumper CAN 120R
- If SERVICE warning appears on the dashboard, take out the 100Ω resistor between pins 2 and 4 of the emulator's plug

4 Start the car.



5 Check the Julie's™ LED behaviour  
 If the procedure is successfully completed the  
 blue LED lights constantly and blinks once every two seconds!

End of the procedure



## Renault ESL 1

### Supported cars

Renault Megane II  
Renault Laguna II  
Renault Scenic II  
Renault Clio III  
Renault Espace IV (phase II)

### 1 Disconnect plug from ESL

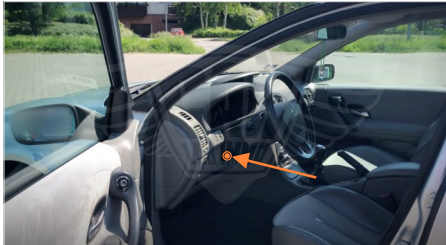

### 2 To choose the program you have to solder specific jumpers on the back of the Emulator: **2 + 3 + 4 + 5 + 6**

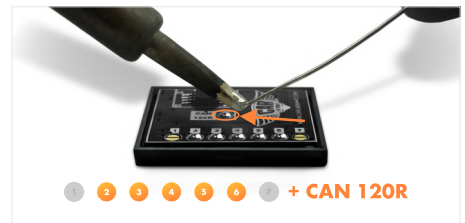
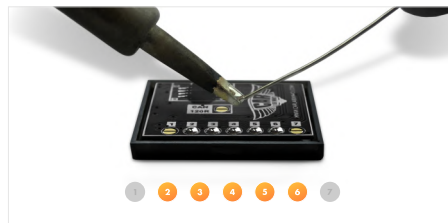

### 3 Connect Julie to the ESL's plug according to the picture on the right.

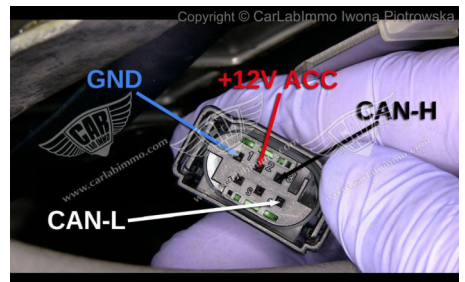
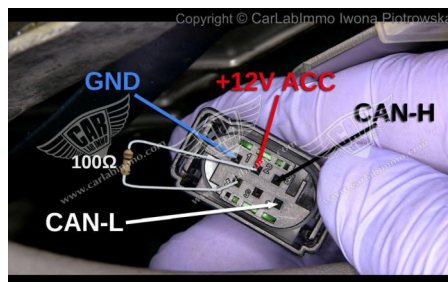

**i Attention!**

- If the Emulator doesn't work, solder an additional jumper CAN 120R
- If SERVICE warning appears on the dashboard, take out the 100Ω resistor between pins 2 and 4 of the emulator's plug

### 4 Start the car.



### 5 Check the Julie's™ LED behaviour If the procedure is successfully completed the blue LED lights constantly and blinks once every two seconds!

End of the procedure